

CONTRIBUTION TO THE COLLECTIVITY
AND THE COMPTOIR ALIMENAIRE - a citizen's response

ATELIER

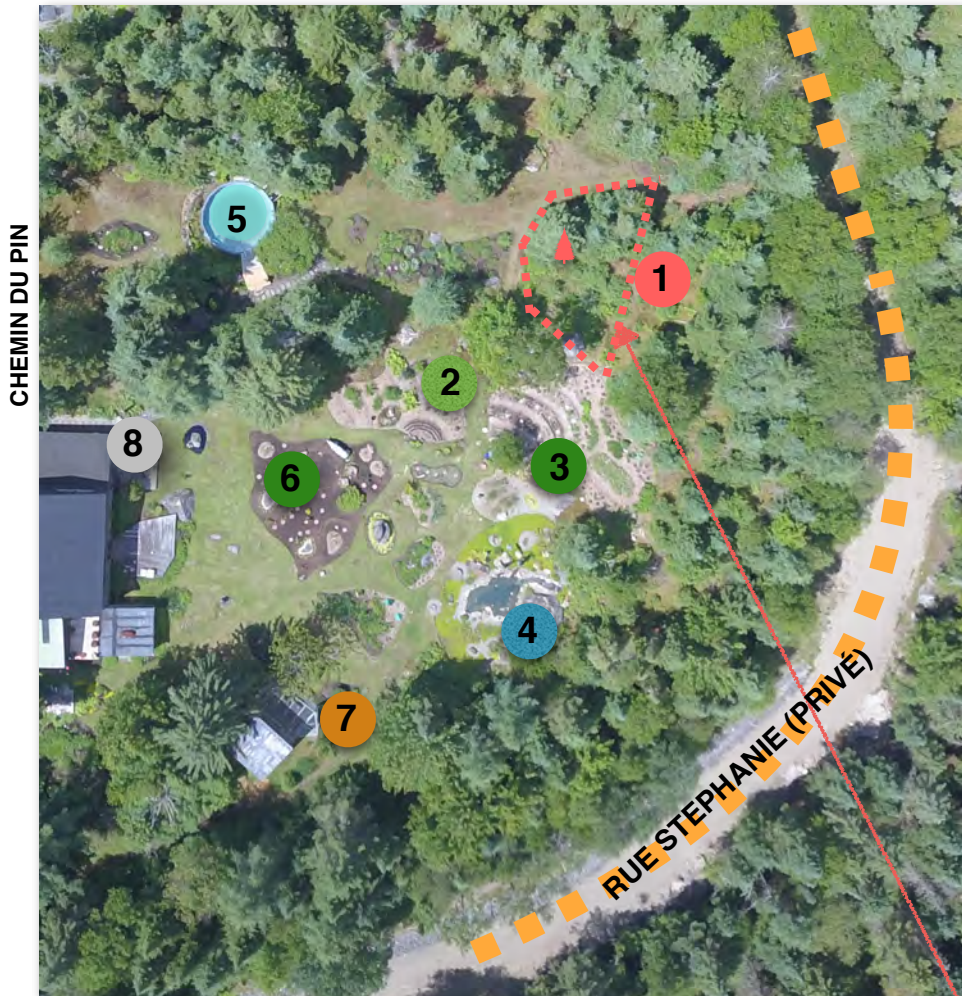

LEGEND	
	1 POTENTIAL GARDEN
	2 PERMA CULTURE
	3 POTAGER
	4 POND
	5 POOL
	6 GARDEN
	7 CHICKENS
	8 HOUSE

CONSIDERATIONS:
light, water, access, marmot control

BUDGET: materials, training, labour

SUGGESTED ADDITIONS:
RAISED GARDENS
4' W x 8' L (18" Height)

SCARABÉE VERTE

BONNIE BAXTER
3224 rue du Pin
(514) 865-1912
baxterb53@gmail.com

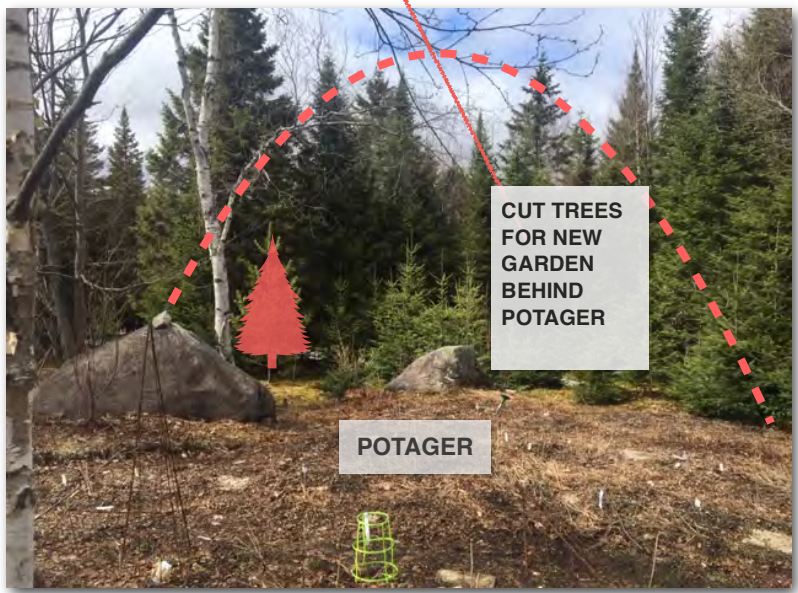

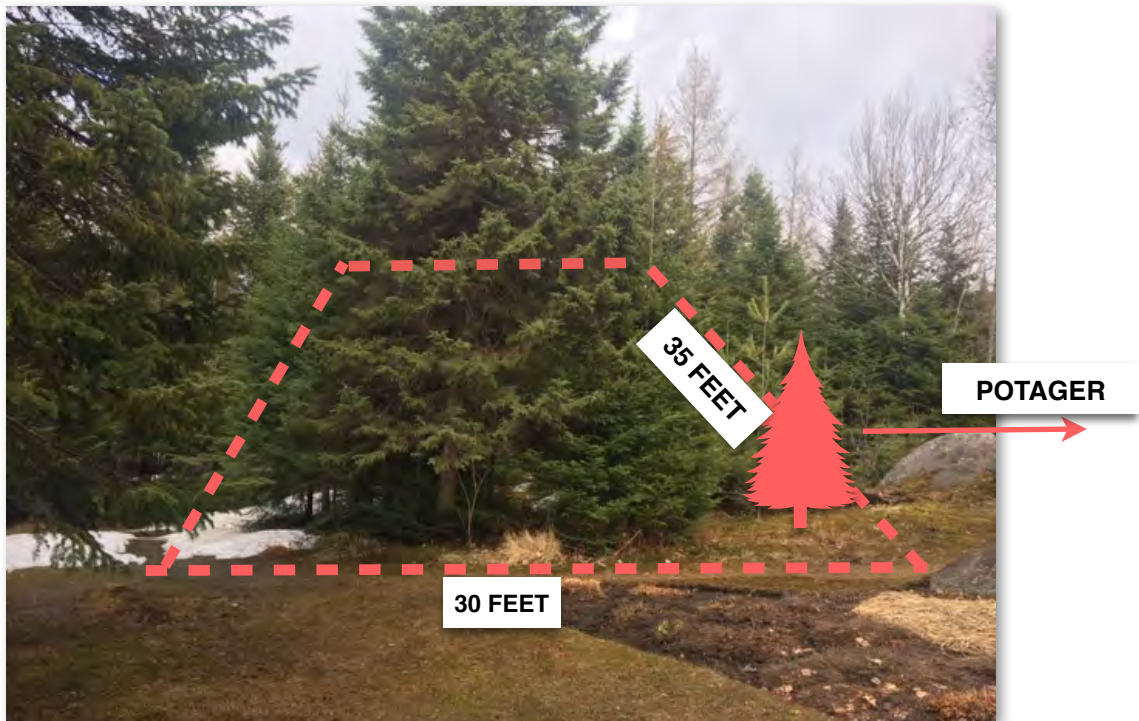

Merci

